

STAPLES

102004435

**Have technical questions?
 Have no fear!**

With Staples® brand remanufactured inkjet cartridges, you get great quality at a great price. Plus, you get free access to our **Product Support** experts:

During weekday business hours, call: 1-800-425-0049

Or visit us online:
www.product-support-staples.com



remanufactured inkjet cartridge
easy installation instructions

We're here to help!
Product Support: 1-800-425-0049

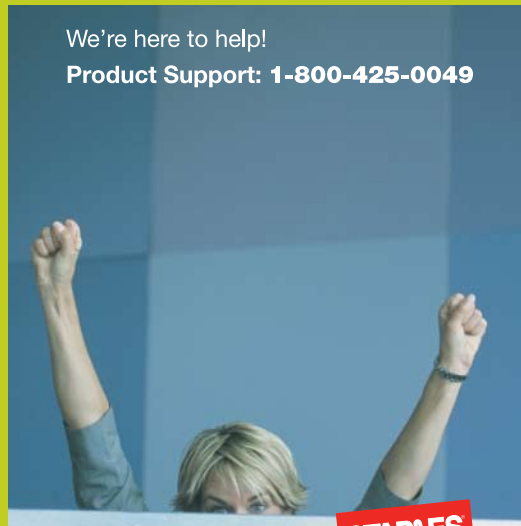

STAPLES

Place your empty cartridge in the enclosed postage-paid mailbag or bring to your local Staples® store. It's a free service from Staples® to you.

Recycling instructions:

Keep cartridge away from direct sunlight, high humidity and extreme temperatures below 50°F (10°C) or above 95°F (35°C).

Storage instructions:

Or visit us online:
www.product-support-staples.com

1-800-425-0049
 during weekday business hours:

Call our **Product Support** experts here are a few helpful tips:
Installation issues?
Printing problems?
Quick questions?

- Remember to follow these **easy installation instructions**.
 - Don't open the package until you're ready to install the cartridge.
 - Keep printing even after receiving a "low-ink" alert – there's still more ink left in your cartridge.
 - Your printer will perform better and last longer when you follow periodic maintenance suggested in your printer manual.
- For best performance from your printer and Staples® brand remanufactured inkjet cartridge, here are a few helpful tips:**

easy installation instructions



English

Remove the old inkjet cartridge per your printer manual. Remove the new cartridge from its packaging. Carefully remove the plastic clip. **Do not touch the ink outlet or copper contact.** Cap color may vary.

Español

Remueva el cartucho de inyección de tinta usado conforme al manual de su impresora. Remueva el nuevo cartucho de su empaque. Remueva cuidadosamente el clip de plástico. **No toque la salida de la tinta ni el contacto de cobre.** El color de la tapa puede variar.

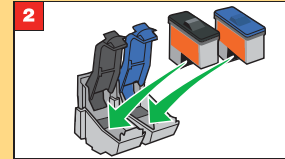

Turn the cartridge so the copper contacts are facing the rear of the printer. Push the cartridge securely in place. **Note: the black cartridge goes on the left and the color cartridge goes on the right.**

Gire el cartucho de manera que los contactos de cobre vean hacia la parte posterior de la impresora. Empuje el cartucho para asegurarlo en su sitio. **Nota: el cartucho de tinta negra va al lado izquierdo y el cartucho de tinta de color va al lado derecho.**

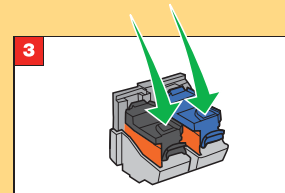

Lower the latch to lock the cartridge into place. The latch should snap firmly down on the cartridge.

Baje el seguro para asegurar el cartucho en su sitio. El seguro debe cerrar firmemente para asegurar el cartucho.

Important Installation Notice
 Please review the enclosed Stop Sheet. If you receive a pop-up message that the ink has been depleted or a low ink warning, please disregard. Check "Don't display this dialog again" and click "OK" or "Continue Printing," if necessary. In the printer status window, since you already have your ink, do not click "Order Ink Online." If you have the option, check "I have ordered my ink, please don't remind me again." If not, close the window and continue printing.

Aviso importante sobre la instalación
 Por favor, revise la hoja de advertencia que se adjunta. Si recibe un mensaje que la tinta se ha agotado, o una advertencia de que el nivel de tinta está bajo, desprecúpese. Marque "No muestre este diálogo otra vez" y haga clic en "Aceptar" o en "Continuar imprimiendo", si es necesario. En la ventana de estado de la impresora, puesto que tienes ya tu tinta, no haga clic en "Ordene tinta en línea." Si tiene la opción, marque "He ordenado mi tinta, no me lo recuerde de nuevo." Si no, cierre la ventana y continúe imprimiendo.

Don't forget:
 Should you encounter print problems, run the "Clean Print Nozzles" as instructed in your printer owner's manual.
 Check your printer manual for additional tips and troubleshooting advice.

If you use an all-in-one machine:
 You may be prompted during installation to select either "New Cartridge" or "Used Cartridge." Even though this is a remanufactured cartridge, **select "New Cartridge."**

Installation issues? Printing problems? Quick questions?
 Call our **Product Support** experts during weekday business hours: **1-800-425-0049**
 Or visit us online:
www.product-support-staples.com