

Staples®

Big & Tall Chair

Randolph

ST62818



Staples®

ASSEMBLY GUIDE

Product Support 800-425-0049

Easy assembly.

Staples® is taking the stress and frustration out of furniture assembly.

More logical instructions. We develop our instructions to have the right amount of detail you'll need for assembly.

We're here to help. If you're confused during any step of the process, just call the number located at the bottom of the instructions pages.
You'll get help from a friendly representative.

Need help with assembly? Questions?

Call our Product Support experts
9:00 am-8:00 pm, Eastern Time
800-425-0049

Elevate your workspace.

Built to last. We rigorously test all our products to meet or exceed industry-leading standards.

We stand behind our products and materials. If for any reason a Staples® product does not meet the performance expectations, please contact us at 800-425-0049.

Sit down on the job in custom comfort.

No two people are alike. But no matter what you're built like, there's one chair that's built for everyone's comfort - the Staples® Brand chair. Take a look at the diagram below. It's packed with features that make it easy to fine-tune the comfort to meet your unique needs.

Product Features

Seat Height Adjustment

Seat height adjusts to assure correct posture and relieves stress on back, thighs and legs.



Variable position Tilt Lock

Variable locking mechanism, fixes back in multiple positions to assure healthy posture.



Tilt Tension

Easy adjustment of chair flexibility avoids heavy pushing and relaxes muscles.



Flipping Arms

Arms can be flipped out of the way so that the chair can be pushed under a desk.



Headrest Height Adjustment

Headrest adjust up and down to ease pressure on neck and support head.



Features Instructions

Seat Height Adjustment

- Pull up on the handle underneath the right side of the seat.
- Lower or raise the seat to your desired height, then release the handle to lock the seat height into position.

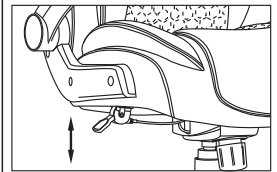

Tilt Lock

- Locate the handle underneath the left side of the seat.
- Push the handle down to allow the chair to tilt.
- Pull up on the handle when selecting preferred tilt lock angle.
- The tilt lock is available at three positions.

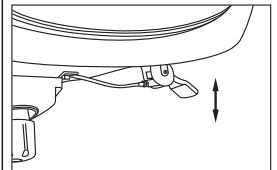

Tilt Tension

- Grasp the knob under the front center of the seat.
- For firmer/stiffer-twist counter clockwise.
- For softer/looser-twist clockwise.

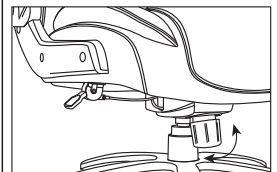

Flipping Arms

- Arms can be flipped out of the way so that the chair can be pushed under a desk.
- Pull arms down for use.

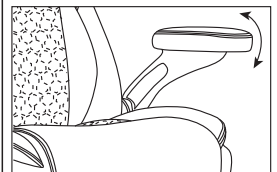

Headrest Height Adjustment

- Slide the headrest up and down to the desired location.

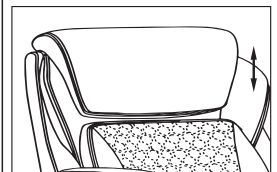

Included Parts

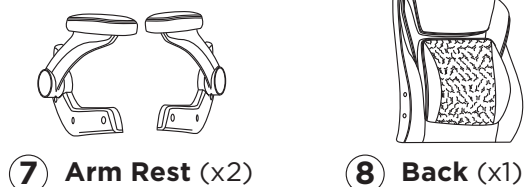
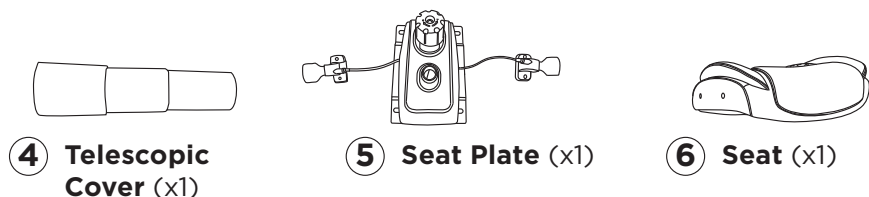
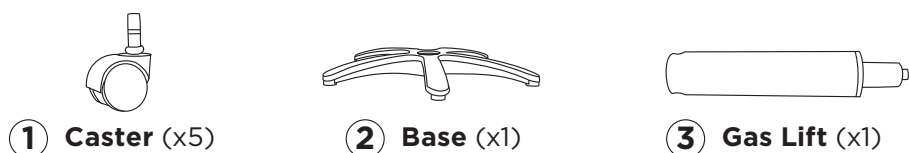

Tools Provided

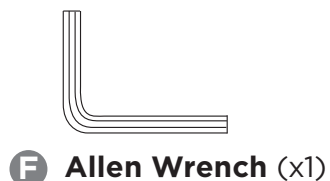

Chair bolts, screws and knobs may loosen during use. Please tighten your chair's hardware each month.

Each piece of hardware needed for each step is located in the corresponding segment in your Easy Parts Pack.

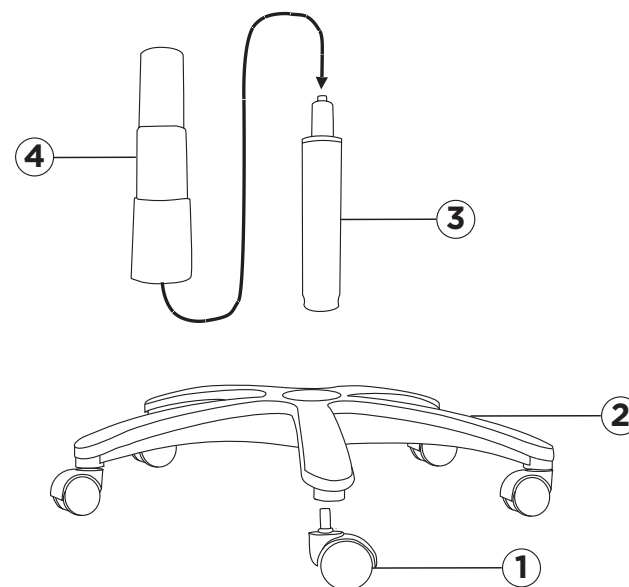
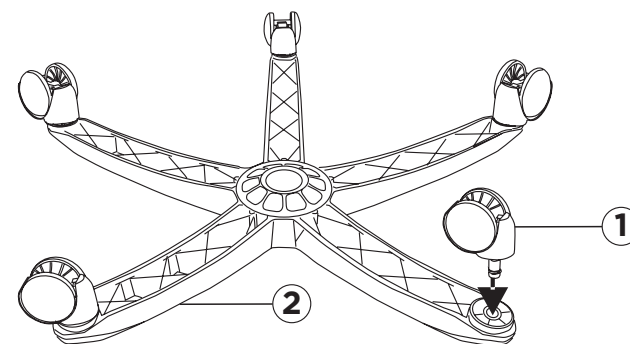
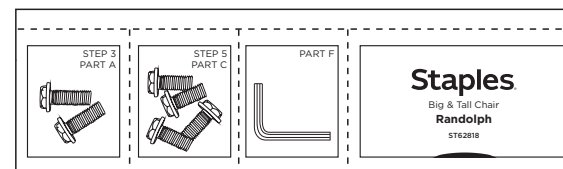

3



A (x2)



B (x2)



C (x4)

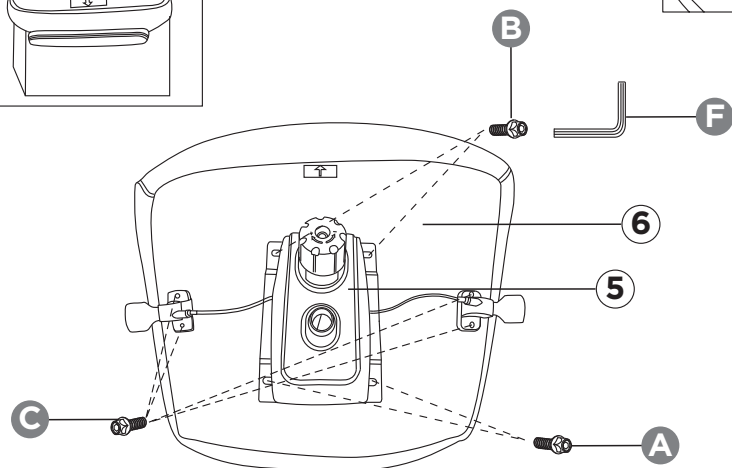
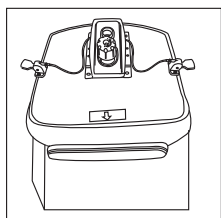

Tip: For easier installation, place seat on top of box.

4

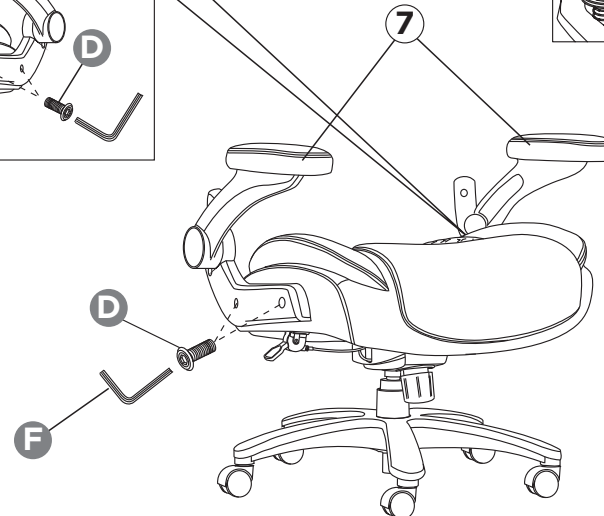
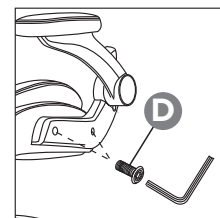
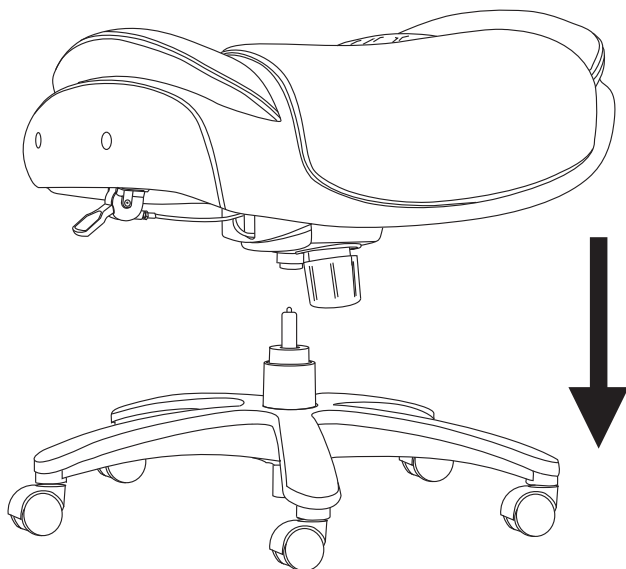

Tip: Use Allen wrench to thread all screws.
Do not tighten screws fully until you have complete assembly.

5

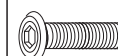

D (x4)

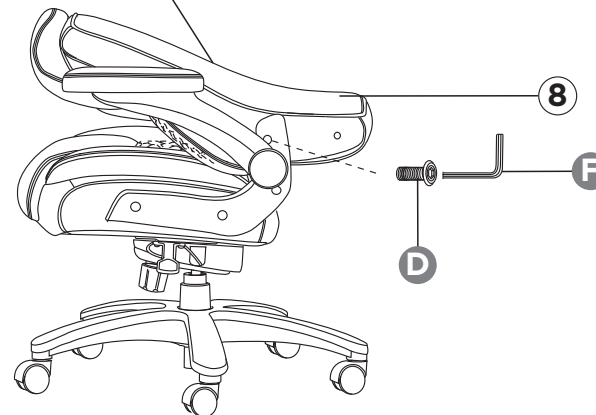
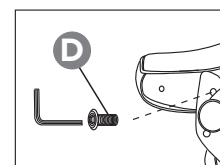
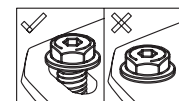

Tip: Use Allen wrench to thread all screws.
Do not tighten screws fully until you have complete assembly.

6

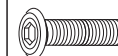

D (x2)

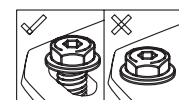

7

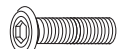
 (x2)

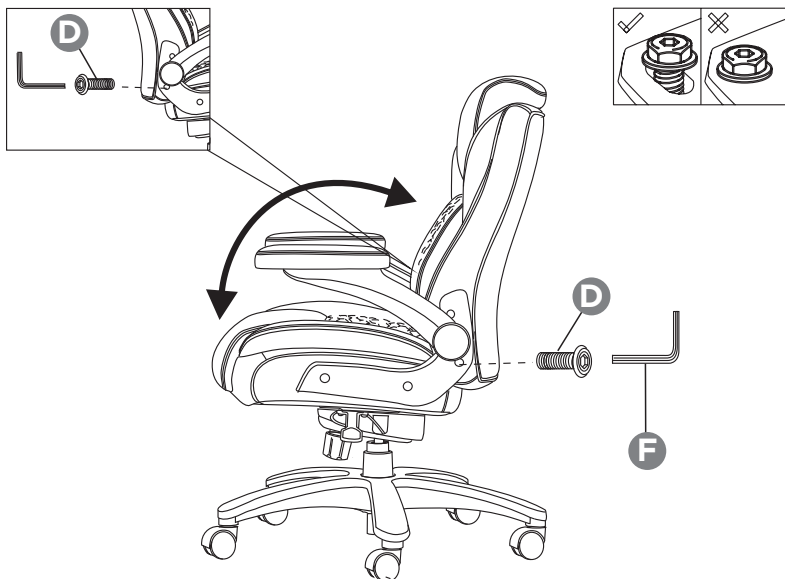

Tip: Use Allen wrench to thread all screws.
Do not tighten screws fully until you have complete assembly.

8

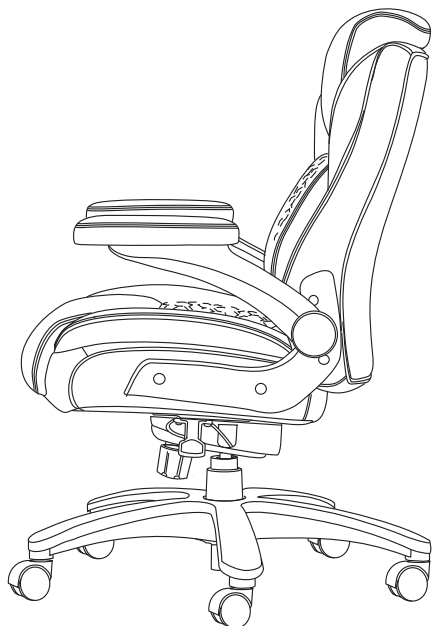

Tip: Tighten all the screws.

9

 (x8)



10



Behold, the finished product.

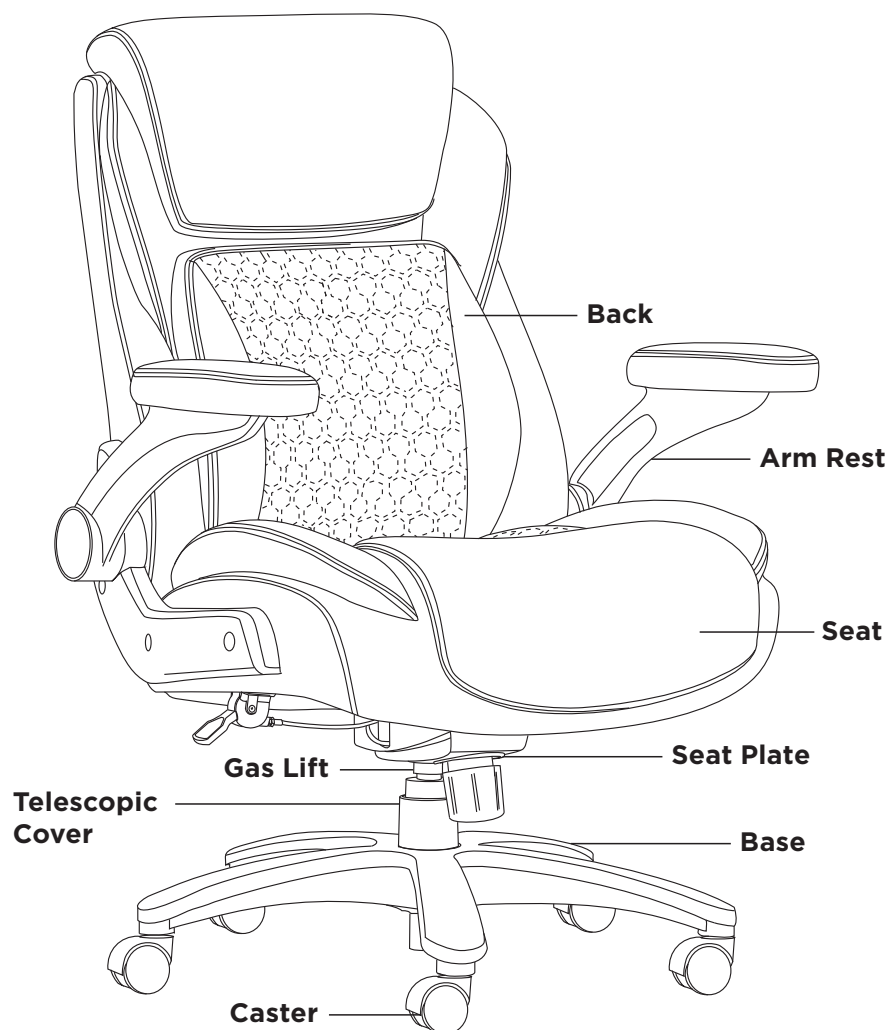

Warranty

Staples Brands warrants to the original purchaser of this Staples® Chair against defects in design, assembly, material, or workmanship for 5 years from the original date of purchase. In the event of a defect in the design, assembly, materials or workmanship of this product within 5 years from the original date of purchase, Staples Brands will replace any such defective part. Parts included under this warranty are non-moving metal components, chair frame, pneumatic cylinder, upholstery and all other parts. To claim your replacement parts, contact product support at 800-425-0049. Original receipt or proof of purchase is required to obtain replacement parts. This warranty is based on up to 8-10 hours of continual use within a 24-hour period for users weighing up to 400 lbs. (181 kgs).

Claims under this limited warranty or any implied warranty shall be limited to replacement of 100% of the chair or refund of purchase price at Staples Brands' sole option.

This warranty does not apply to normal wear or damage from misuse, abuse, improper storage or handling, installation, accident, repair or alteration or other circumstances not directly attributable to manufacturing or material defects.

THIS WARRANTY IS EXCLUSIVE AND IN LIEU OF ALL OTHERS, WHETHER ORAL OR WRITTEN, EXPRESS OR IMPLIED. STAPLES BRANDS SPECIFICALLY DISCLAIM ANY AND ALL IMPLIED WARRANTIES, INCLUDING WITHOUT LIMITATION, WARRANTIES OF MERCHANTABILITY AND FITNESS FOR A PARTICULAR PURPOSE. IN NO EVENT WILL STAPLES BRANDS BE LIABLE FOR ANY INCIDENTAL, DIRECT, INDIRECT, SPECIAL, PUNITIVE, OR CONSEQUENTIAL DAMAGES (SUCH AS BUT NOT LIMITED TO, DAMAGES FOR LOSS OF PROFITS, BUSINESS, SAVINGS, DATA OR RECORDS) RELATED TO THIS PRODUCT.

This warranty gives you specific legal rights, and you may also have other rights that vary depending upon the state, province, territory or country. Some states, provinces and territories do not allow the exclusion or limitation of incidental or consequential damages or limitation on how long an implied warranty lasts.

Except as stated herein, no other warranties shall apply.